

## Triangular profile lighting for corner and edge applications

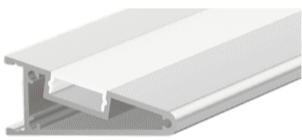

**Profile Photo**

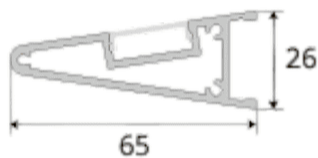

**Profile Dimension**



**Product Picture**

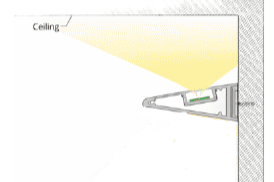

**Light Direction**

Technical Specifications	
<b>Code</b>	SLL6526Z
<b>Size</b>	65 x 26 mm
<b>CRI</b>	85+
<b>Input Power</b>	24 V DC
<b>IP Rating</b>	IP40/IP54

Custom Options Available	
<b>DIFFUSER</b>	PMMA Diffuser (Opal, White, Frosted)
<b>CCT</b>	2200K/2700K/3000K/3500K/4000K /5000K/6000K/6500K , Tunable White, RGB, RGBWW, RGBA
<b>Watts/M</b>	9.5W - 32.5 W
<b>Beam Angle</b>	120 Degrees
<b>Finish</b>	Custom Size and Custom Powder Coating finish or Anodized finish available upon request as per RAL code
<b>Application</b>	Angular Wall Washing, Angular Ceiling Highlighter

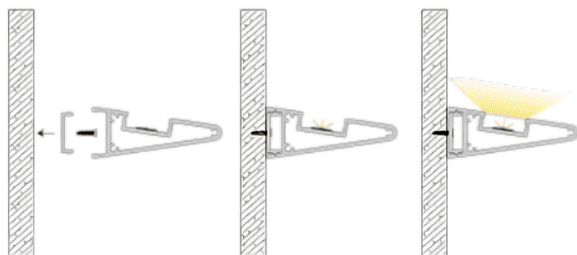

**Installation Guide**

### Installation Accessories

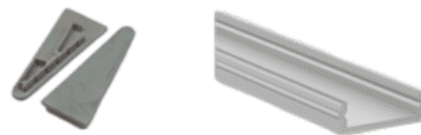

**End Caps    Mounting Accessories**

### Light Direction Plot

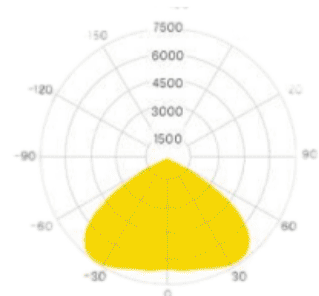

120°