

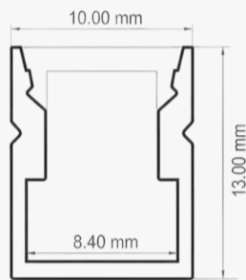

Profile Picture



Profile Dimension



Product Picture

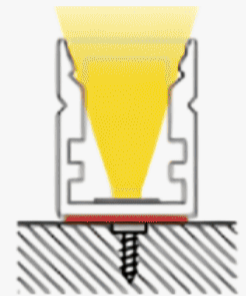

Light Direction

Technical Specifications	
Code	SLL1013
Size	10 x 13 mm
CRI	85+
Input Power	24 V DC
IP Rating	IP40/IP54

Custom Options Available	
DIFFUSER	PMMA Diffuser(Milky,Frosted)
CCT	2700K/3000K/4000K/5000K/6500K
Watts/M	4.5W - 11.5 W
Light Angle	120 Degrees
Finish	Custom Size and Custom Powder Coating finish or Anodized finish available upon request as per RAL code
Application	Under Cabinet, Kitchen Lighting, Furniture & Joinery, Decorative Lighting, Architectural Accent Lighting, Display Shelving

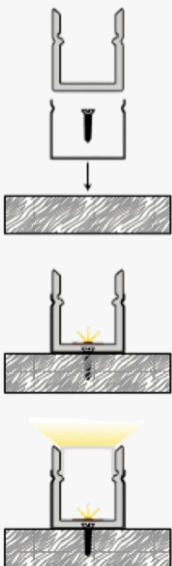

Installation Guide

Installation Accessories



End Caps

Mounting Clips

Light Direction Plot

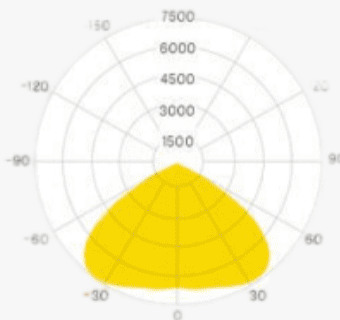

120°